

SCHOCK



SINK GREEN

SCHOCK SINKS AND TAPS - HIGHLIGHTS 2022

1810
A SCHOCK GROUP COMPANY

CONTENTS

SCHOCK at a glance	4
SINK GREEN	6
World of materials	10
CRISTADUR®	14
CRISTADUR® Green Line	20
CRISTALITE®	24
Quartz composite kitchen sinks	28
Mixer taps	44
Service	46
Placing an order	46
Perfectly fitted – installation variants	48
Under the microscope – mixer tap details	49
Service hints and care tips	50

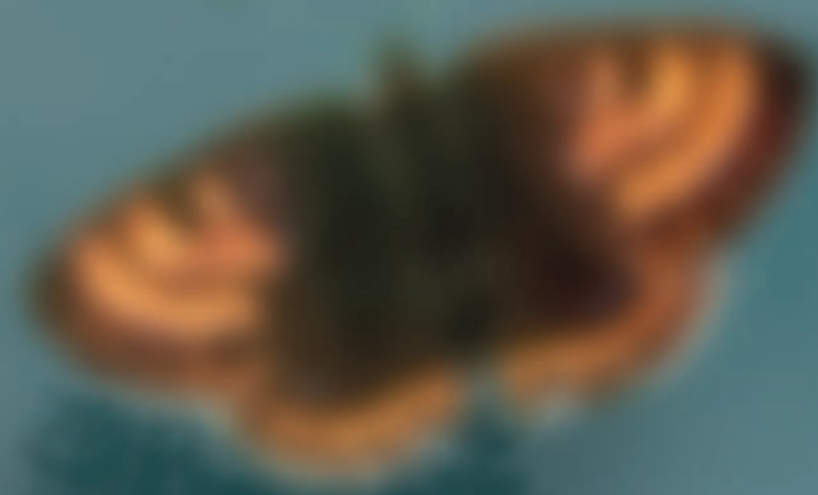

Your SCHOCK companions

We accompany you through the colourful world of SCHOCK in this brochure and summarise important facts in brief.



WHO ARE WE?

Since 1979 when we invented the quartz composite sink, we have always pursued the same goal across all parts of the business: To pour all our innovation, passion and craftsmanship into making life around the kitchen sink more beautiful, more convenient and more colourful in ever new ways.

The mixture of handmade quality and innovative technology, of Made in Germany and a strong position on the global markets, of pioneering spirit and a sense of tradition, of passion and expertise is what has made us over the past decades into what we are today: a company with continuous growth, able to look back on a long and successful history and to go on writing new chapters in our story every day.

1924 Company was founded



Headquarters: Regen, Bavarian Forest



Production of SCHOCK sinks exclusively in Germany

1979 We invented the quartz composite technology



- 700 employees

DID YOU KNOW THAT...

...as an innovative company, we hold over 100 patents?

...we have over 200 sink models in over 40 colours?

...more than 60% of all quartz composite sinks worldwide are produced using our process?

> 100

> 200

> 60%

SCHOCK is the inventor of the quartz composite sink.



SINK GREEN



OUR PATH TO A SUSTAINABLE FUTURE

As the innovator of the quartz composite technology, “future” is our speciality.

SINK GREEN is our path to a sustainable future through constant optimisation of our processes on all levels. From the regional sourcing of our natural quartz sand to our short supply chains and our careful selection of suppliers to innovative projects for the benefit of our employees.

We have already passed some important milestones on this journey – such as halving our water consumption and implementing our ambitious energy management system certified to ISO 50001.

But we never stand still. After calculating our detailed carbon footprint according to the GHG protocol, we have reached the next stage: carbon neutrality through

- switching to green electricity from hydropower or planning the use of other renewable energy sources in coordination with energy suppliers and
- offsetting carbon emissions for the company and all sinks via certified projects in accordance with the gold standard. We are working together with ClimatePartner here.
- And further steps are already being planned.



SINK GREEN is our journey and our destination and it spurs us on to develop innovative technologies and world firsts like the CRISTADUR® Green Line.



IGGY POP and the story of SINK GREEN – The story of SINK GREEN and the Green Team is not a myth or a modern fairytale. It’s our story. One that reaches way back into the past and looks far ahead to the future. A story of the invention of the quartz composite sink, of roots, values and new horizons and a story of the future, a future that we want to shape for ourselves and for the generations to come – All Days for Future.

This story is told by punk legend Iggy Pop, our dazzling green ambassador. His words are the common thread running through our yesterday, our today and our tomorrow – and running through this booklet.

“A long, long time ago, everything here was under the sea. When the water went away all the sand remained – the quartz sand. And a mysterious forest was created on it: the Bavarian Forest. Time went by, nothing ever changed again. Then one day, not far from here, some dudes invented a sink made of quartz sand. Beautiful sculptures – well known and in demand all over the world. Now they have created something even more genius: the sustainable sink. Sinks built in harmony with nature.”

This is the beginning of SINK GREEN.”



THE STORY



SINKS MADE OF QUARTZ SAND

The quartz sand from our region, which at up to 75% is the main constituent of our sinks, is naturally hard. To be precise, it's the hardest constituent of granite, which means that it plays the leading role in producing our durable, robust and multifaceted material finishes. At our factory in the Bavarian Forest, it is processed into our quartz composite kitchen sinks.



WORLD OF MATERIALS

OUR MATERIALS: CRISTADUR® AND CRISTALITE®
THE DIFFERENCES IN BRIEF:

CRISTADUR®

PREMIUM



Patented premium finish with silky-smooth feel

Intensive colours from pure white to jet black

Dirt repellent effect makes it extremely easy to clean

Flush-mount installation and many premium features

Made to last and sustainable

CRISTADUR® Green Line
~ 99 % based on renewable, natural or recycled raw materials; can be returned into our closed production cycle at the end of its life*

CRISTALITE®

CLASSIC



Stony finish

On-trend material available in many fashionable shades and natural-looking colours

The classic SCHOCK sink

Beautiful in appearance and attractive on price

CRISTADUR® AND CRISTALITE®

PRODUCT BENEFITS

THE STUFF SINK DREAMS ARE MADE OF

SCHOCK sinks consist predominantly of natural quartz sand. The silky-smooth matt finish of CRISTADUR® and the stony finish of CRISTALITE® were specially developed for the demands of the kitchen. The rigours of everyday use leave barely a trace on our proven material technology.



Dirt repellent effect
The dirt simply rolls off

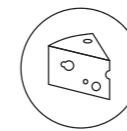

Odour free
Leaves the surface free of smells
DIN 10955

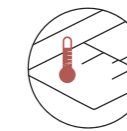

Heat resistant
Not temperature sensitive up to 180°C DIN
EN 13310



Food safe
Absolutely safe material
DIN EN 1186



Easy to clean
Poreless surface for an extremely easy-clean, hygienic finish.

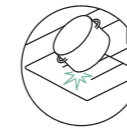

Impact resistant
Tough and hard-wearing material
DIN EN 438-2

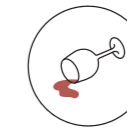

Fade resistant
Resistant to food stains
DIN EN 13310



Made to last
Extremely durable
DIN EN 13310

* Pilot projects in Germany and Austria



ClimatePartner.com/
14214-2103-1001



CRISTADUR®

THE PREMIUM SATIN MATT FINISH

The patented premium material wins fans with its poreless structure and beautifully shimmering finish - the dirt simply rolls off. This makes it exceptionally easy to clean as well as being hard-wearing and made to last. Extra-special: our sinks carry the Quooker® proved label thanks to special testing with boiling water taps.

And because we believe in our quality handmade in Germany, we give consumers the possibility to extend their warranty* on CRISTADUR® sinks to 15 years - in other words, a kitchen's lifetime.

The shimmering, silky-smooth finish comes in eleven intense colours from white to jet black. And if you like it loud, you can even have bright red.

CRISTADUR®



*Special order only, please allow 4 weeks



*ClimatePartner.com/14214-2103-1001

The premium CRISTADUR® finish is not only exceptionally easy to clean, it is also Quooker® proved.

*Consumers have had the possibility to extend their warranty for all CRISTADUR® sinks since 1 January 2020. The stipulated warranty conditions apply. You can find the details at www.schock.de/gbr_en/warranty



CRISTADUR®



45

50

60

60

80

90

Corner unit

GREENWICH N-100S



GREENWICH N-100



GREENWICH N-150

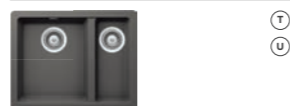

available until 31.12.2022

PREPSTATION D-150**

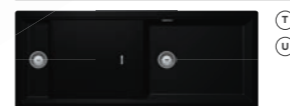

GREENWICH N-100XL



KALLIO M-175

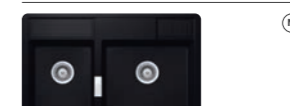

SIGNUS C-150*



KYOTO D-100



MONO D-100

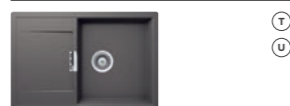

GREENWICH N-100L



SIGNUS D-100L

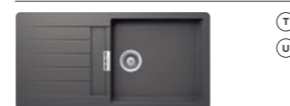

GREENWICH N-200



SIGNUS N-200



MONO D-100S



MONO N-100S



KYOTO D-150



SIGNUS D-150

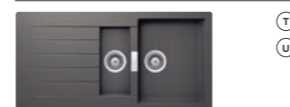

MONO D-200

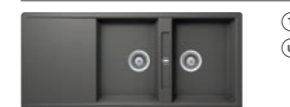

MONO R-100



TIA D-100



MONO D-100XS

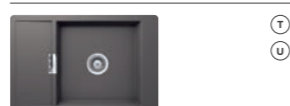

TIA D-100LS



SIGNUS D-200

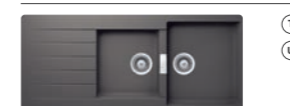

SIGNUS D-100



WATERFALL D-100



MONO D-100L



TIA D-100L



SIGNUS C-150*



MONO D-150



MONO N-100



WATERFALL D-150



*Note: The indicated cabinet width is for installation in a corner cupboard. If the sink is not being installed in a corner cupboard, an 80 cm base cabinet is required.

● = CRISTADUR® Green Line

⊕ = Topmount ⊖ = Undermount ⊗ = Modular

**For installation in two 60 cm base cabinets or one 120 cm base cabinet





CRISTADUR® sink model **Greenwich N-100L** in Puro



CRISTADUR® sink model **Signus D-200** in Polaris



CRISTADUR® sink model **Mono D-100L** in Stone



CRISTADUR® sink model **Tia D-100L** in Magma



CRISTADUR® Green Line

GENUINELY SUSTAINABLE. GENUINELY PREMIUM.

With resource-saving production in Germany, natural quartz sand from Bavaria and raw materials efficiency of 90%, all of our quartz composite sinks are already made to high standards of environmental awareness and sustainability. Plus, with the CRISTADUR® Green Line, we have now developed a material that is ~99% made from natural, renewable or recycled raw materials.

The result? The most sustainable quartz composite sink from SCHOCK.

Sinks ~99% based on natural, renewable or recycled raw materials

- Natural quartz
- Natural colour additives
- Binders from recycled or renewable raw materials

CRISTADUR® Green Line

Day DAY (74)
Night NGT (75)
Twilight TWI (76)



*ClimatePartner.com/
14214-2103-1001

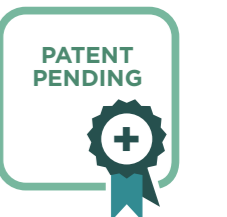

* Pilot projects in Germany and Austria

CRISTADUR® GREEN LINE

GREENWICH N-100L*



MONO D-100XS



MONO N-100S



GREENWICH N-100XL*



MONO D-100S



MONO N-100



GREENWICH N-200*



MONO D-100



MONO R-100



KALLIO M-175



MONO D-100L



PREPSTATION D-150

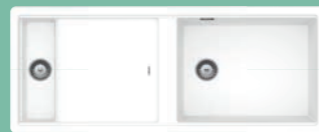

MONO D-150



SC-510



SC-520



SC-530

SINK GREEN ■■■■

* only available in Green Line colours until 31.12.2022

Green now comes in pure white, jet black or taupe: The CRISTADUR® Green Line - The CRISTADUR® Green Line is available in these fantastic colours. Having premiered our pure white in 2021 with the colour Day, along with its jet black counterpart, Night, we have now launched Twilight, a special shade of taupe that brings the nude trend into the kitchen. And the best thing about it? All of the sustainable colours are green at heart.



Night NGT (75)

Twilight TWI (76)

Day DAY (74)

CRISTALITE®

THE COMPOSITE SINK FOR BEGINNERS AND TRENDSETTERS ALIKE

CRISTALITE® is our classic, and it is constantly setting new trends in the contemporary kitchen with many fashionable shades of colour. The CRISTALITE® surface finish is stony to the touch and is a reminder that even this on-trend material is made from the hardest constituent of granite – natural quartz sand.

The CRISTALITE® finish is hard-wearing and easy to clean, making it the embodiment of long-lasting cooking pleasure.

CRISTALITE® BASIC LINE

	Nero GNE (13)
	Asphalt GAS (43)
	Croma GCR (49)
	Alpina GDW (07)



Optimised
material
formula



Stony finish



proHygienic 21



*ClimatePartner.com/
14214-2103-1001

The SCHOCK classic – beautiful in appearance and attractive on price.



CRISTALITE®



45

EURO R-100



Ⓣ

50

PINEDO D-100



Ⓣ

Ⓧ

PINEDO D-100XS



Ⓣ

Ⓧ

QUADRO N-100S



Ⓣ

TYPOS D-100



Ⓣ

Ⓧ

60

PINEDO D-100L



Ⓣ

Ⓧ

PINEDO D-150



Ⓣ

Ⓧ

QUADRO N-100



Ⓣ

60

QUADRO N-150Y*



Ⓣ

*available from Q4 2022

TYPOS D-100L



Ⓣ

Ⓧ

TYPOS D-150



Ⓣ

Ⓧ



Ⓣ = Topmount Ⓧ = Undermount

BEAUTIFUL SCULPTURES

When *one day, not far from here, some dudes invented a sink made of quartz sand*, that was not the end of the story. Quite the opposite: It was only the beginning. Since then, we at SCHOCK have been constantly reinventing ourselves and our design. A new story: The Pinedo sink series, featuring four models, maximum planning flexibility and our premium finish.



- 1 CRISTALITE® sink model **Pinedo D-100L** in the colour **Nero**
- 2 **Custom-fit chopping board** in **matt-black look** in the sturdy fibre composite material **Fibre Rock**



1 CRISTALITE® sink model **Pinedo D-100XS** in the colour **Nero**



D-100XS D-100 D-100L D-150

ANOTHER CHAPTER: THE FLEXIBLE, ENTRY-LEVEL RANGE

Different external dimensions, bowl sizes and drainboards, a brilliant intensity of colour and proven CRISTALITE® quality: The Pinedo models D-100XS, D-100, D-100L, and D-150 give you flexibility and a happy end from the start.



1 CRISTALITE® sink model **Pinedo D-150** in the colour **Nero** 2 Functional upgrade: **Foldable designer draining rack** in **Brushed Copper** to serve as a drainer or a place to put produce or cooking utensils



- 1 CRISTADUR® sink model **Tia D-100** in the colour **Polaris** with useful lip for hanging customised accessories in the sink 2 Functional upgrade: **7-piece multifunctional bowl set** in **plastic finish** 3 **Custom-fit wooden chopping board** in **bamboo**
- 4 CRISTADUR® sink model **Tia D-100LS** in the colour **Puro**
- 5 Designer upgrade: **Matching trim** in **stainless steel** 6 **Comfopush** in **stainless steel** to automatically open and close the pop-up waste at the push of a button 7 Functional upgrade: **7-piece multifunctional bowl set** in **plastic finish**, plus a rack for hanging **Gastronorm** containers or other kitchen utensils in the sink 8 **Custom-fit chopping board** in **black** look in the sturdy fibre composite material **Fibre Rock**

EVEN MORE GENIUS

The sink as a kitchen assistant – What could be even more genius than a SCHOCK sink? A SCHOCK sink that assists you with cooking and preparing meals and prepping fresh produce. And how could that look? Like the three models in our Tia range, with an integrated lip for hanging custom-fit accessories in the sink. Whether it's steamer baskets, functional bowls or chopping boards, the large Prepstation D-150 or the Tia D-100LS as a multifunctional space saver for the smaller kitchen, our food prep assistants are as individual as your kitchen.

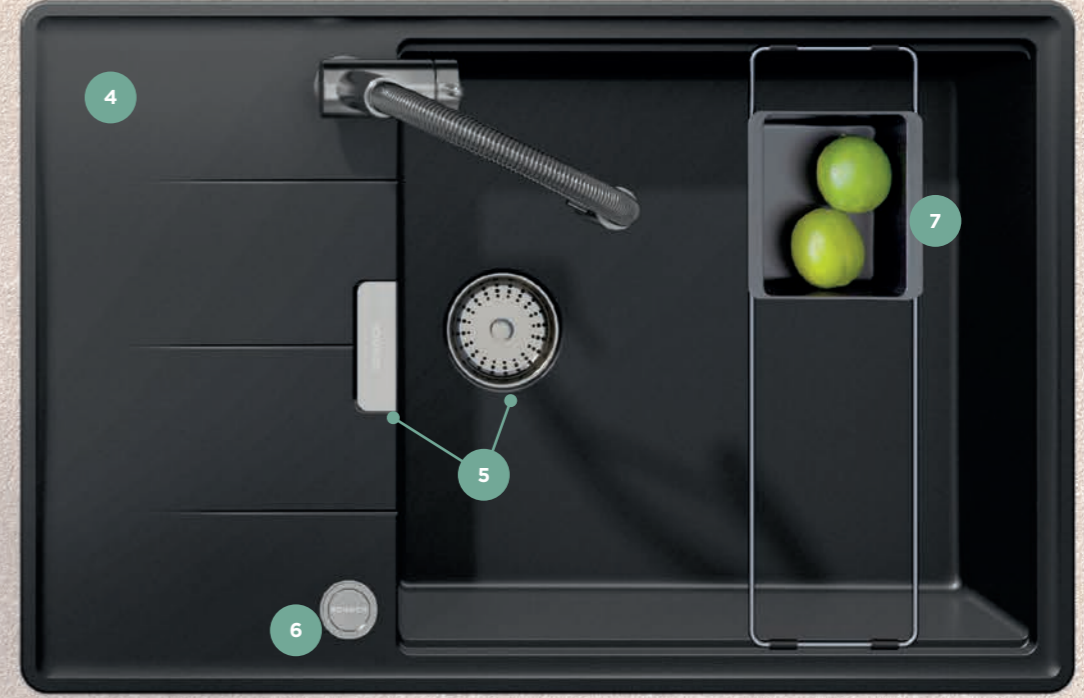



Versatile food prep assistants – You can't avoid a bit of dirt and water when prepping fresh fruit and veg, but our extremely easy-to-clean CRISTADUR® products keep it all right there at the sink.

1 CRISTADUR® sink model **Greenwich N-200** in the colour **Silverstone** and undermount installation 2 Functional upgrade: **Multifunctional rack** for hanging Gastronom containers in the sink; various **Gastronorm containers** to support fresh food prep at the sink 3 **Foldable designer draining rack** in **Black Metallic**

4 CRISTADUR® multifunctional **Prepstation D-150** in the colour **Night** 5 Designer upgrade: **Matching trim** in **stainless steel** 6 Functional upgrade: **Multifunctional rack** for hanging Gastronom containers in the sink to support fresh food prep 7 **Wooden chopping board** in bamboo

BUILT IN HARMONY WITH NATURE

An earthy shade given a fresh interpretation? A shade of colour that goes well with nude, the latest interior design trend and yet never goes out of fashion? Sure thing: The colour Twilight is the latest addition to the CRISTADUR® Green Line and, as a matt shade of taupe, is the perfect complement for trendy grey tones, minimalist black and white, light wood and timeless natural stone. And ideally suits contemporary kitchen architecture.

❶ CRISTADUR® **Greenwich N-100XL*** undermount sink in the Green Line colour **Twilight** with integrated lip and large-volume bowl ❷ Design upgrade: **Matching visible parts in stainless steel** ❸ Functional upgrade: **Movable silicone drain mat** with drip lines for excess water



Twilight

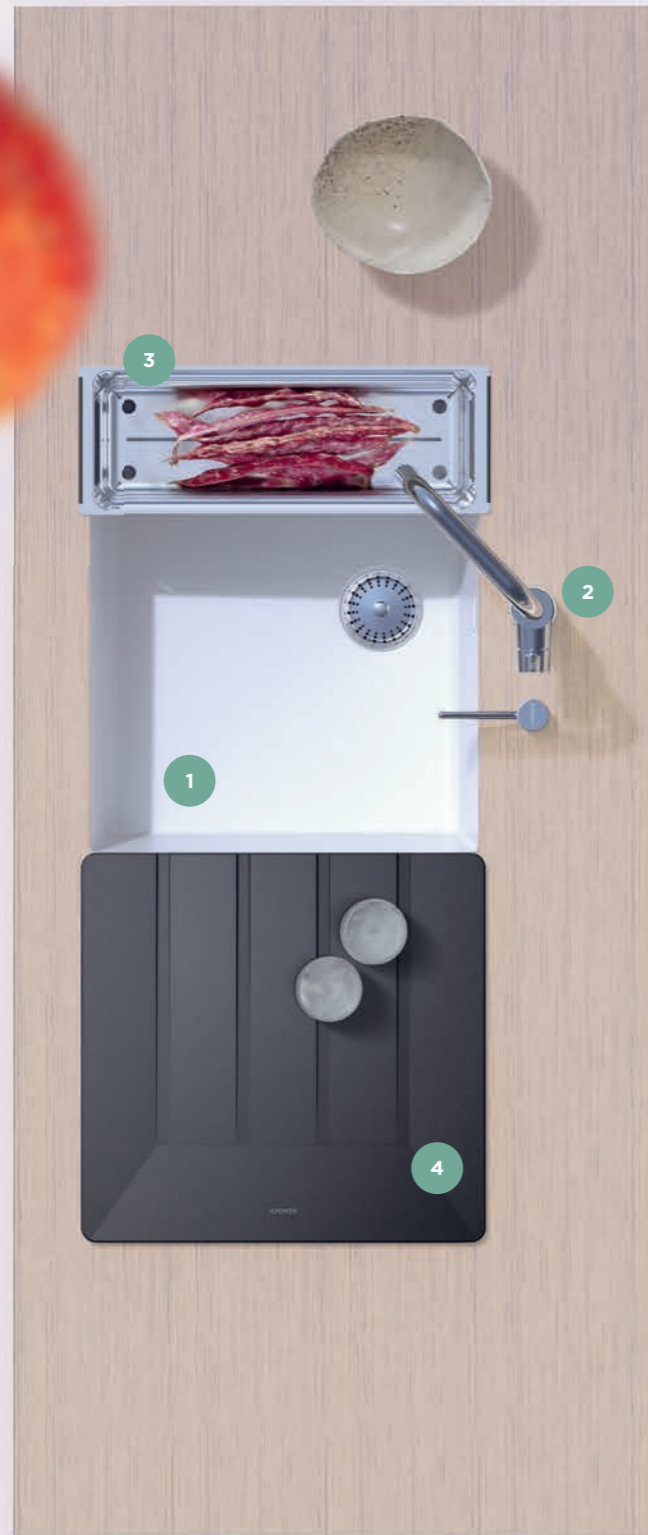

1 CRISTADUR® sink model **Greenwich N-100L*** in the Green Line colour **Day** and undermount installation 2 Mixer tap **SC-530** in the colour **Day** 3 Functional upgrade: **Multifunctional bowl** in stainless steel 4 Functional upgrade: **Portable drain mat** in **silicone** with drip lines for excess water

* only available in Green Line colours until 31.12.2022





1 CRISTADUR® sink model **Mono D-100** in the Green Line colour **Night** 2 Mixer tap **Keto** in **White Gold**
3 Designer upgrade: **Matching trim** in **White Gold** 4 Functional upgrade: **Custom-fit wooden chopping board**



Farmhouse look in pure white? Sure! Our Kallio M-175 in the colour Day.

1 CRISTADUR® sink model Kallio M-175 in the Green Line colour Day 2 Mixer tap Kavus in Gunmetal 3 Designer upgrade: Matching trim in Gunmetal

KALLIO M-175 - A MODULAR DESIGN HIGHLIGHT

Contemporary modular sink for farmhouse or Scandi-style kitchens with a functional design brief. The Kallio M-175 boasts spacious bowls with room for large pots and pans. The front edge of the bowl is slightly slanted, perfect for leaning baking trays against it for intensive cleaning.

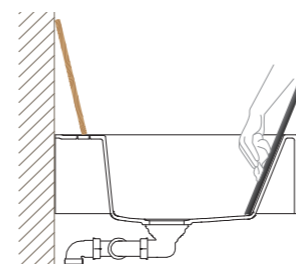

SCHOCK MIXER TAPS

DREAM TEAM: SCHOCK MIXER TAPS TO MATCH THE KITCHEN SINK

There's no SCHOCK sink without the right tap! SCHOCK offers a broad choice of modern and high-end mixer taps to create a perfect team in the kitchen sink. Of course, the tap must not only suit the kitchen and the SCHOCK quartz composite sink but must also meet your individual needs in the kitchen.

FORM

SPOUT TYPE

LOOK

The classics – metal finish

- Stainless Steel

The trend-setters – matching the stylish sink trim

- White Gold
- Copper
- Gunmetal

The coloured option – matching your CRISTADUR® or CRISTALITE® colour with a special coating or our patented sleeve technology in the same finish as your sink

We offer kitchen taps to suit every need and any style.



MIXER TAPS



KAVUS EDM WGO COP
GUM



KETO EDM WGO COP
GUM



SC-510 CD CT G



SC-520 CD CT G



SC-530 CD CT G



 Fixed spout	 CRISTADUR®	 CRISTALITE®	 CRISTADUR® GREEN LINE
 White Gold	 Copper	 Gunmetal	 Solid stainless steel

PLACING AN ORDER HELPFUL INFORMATION

The article number describes the complete configuration of a SCHOCK sink.

MONN100AMAG

- M**: Abbreviation for model family (Here: Mono)
- N**: With drainer
- N**: No drainer
- M**: Modular
- C**: Corner sink
- R**: Round sink
- 100**: Number and size of bowls (One standard bowl)
- 150**: One standard bowl and one half-bowl
- 200**: Two standard bowls
- A**: Type of installation: Topmount
- U**: Undermount
- M**: Modular
- AG**: Abbreviation for colour (Here: Magma)

The article number describes the complete configuration of a SCHOCK mixer tap.

518000EDM/UK

- 518**: Numbers 1-3: Description of model family (Here: Keto)
- 000**: The last three numbers provide information on the spout and type of mixer tap: Fixed spout
- EDM**: Abbreviation for material/colour finish: Solid stainless steel
- CHR**: Chrome
- WGO**: White Gold
- COP**: Copper
- GUM**: Gunmetal
- UK**: Annex for UK-version

In the case of coloured mixer taps, the abbreviation for the SCHOCK colour is shown here.

STEP BY STEP PLACING AN ORDER

1 SELECT A SINK MODEL AND DON'T FORGET TO READ THE MODEL INFORMATION

MODEL INFORMATION

- Cabinet width
- Sink's inside dimensions
- Cut-out dimensions
- Type of installation

Choice - Our sinks come with automatic drain fittings and pop-up control as standard. We can also supply manually operated drain fittings on request. In this case, please specify this separately when you place your order.

2 DECIDE WHAT TYPE OF INSTALLATION YOU WANT

Topmount Undermount

Individuality - To enable you to coordinate your sink with the material and thickness of your worktop, almost all sink models are available for topmount and undermount installation. Please note the technical information on the product pages.

3 CHOOSE A COLOUR

CRISTADUR®

CRISTALITE®

Variety - The colour summary tells you which colours are available in CRISTADUR® and CRISTALITE®.

4 ADD THE IDEAL MIXER TAP

Please enter the matching article number in your order. If you're ordering a coloured tap that is not the same colour as your sink, we would appreciate a quick note with your order telling us that this is intentional.

5 ADD ANY SPECIALS YOU'D LIKE

Multifunctional - Custom-fit accessories such as functional bowls or chopping boards are available for various models. Please note the difference between included and optional accessories on the product pages.

6 MATCHING TRIM

Aesthetic - Give your CRISTADUR® sink a visual upgrade and colour-coordinate your chosen mixer tap with trim parts in stainless steel, White Gold, Copper, Gunmetal or Puro*. You'll find the article numbers under optional accessories.

* available from 01.01.2023

7 ADD CARE PRODUCTS

Flawless - Specially developed care products complement your order and offer the perfect way to keep all SCHOCK sinks clean and looking good.



PERFECTLY FITTED SINK INSTALLATION TYPE

Think a sink is just a sink? Far from it! Besides the selection of colours and models to choose from, you can also individualise your sink with the type of installation you opt for. Please see the product range summaries or the individual product pages for the different options available.



Topmount installation

Classic installation type, dropped in from above, for all SCHOCK sink models and all worktop materials.

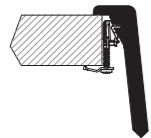

Undermount installation

Fashion-forward installation type for the majority of SCHOCK sink models and matching worktop materials.



Modular installation

Typical of a farmhouse kitchen, the modular sink can be installed between two worktops or in a suitable notch. Overhang varies depending on kitchen planning.

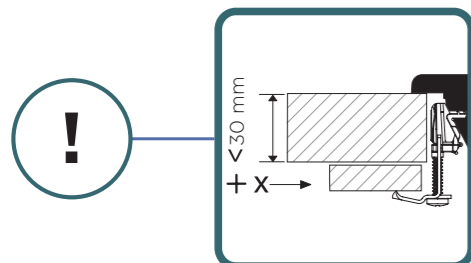
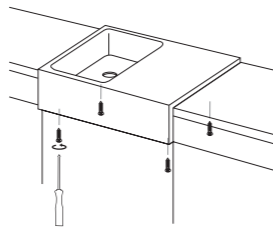

Recommended minimum worktop thickness:

Please note that if the sink is going to be installed with the help of our mounting brackets, we recommend a worktop thickness of 30-40 mm to ensure optimal grip. If the worktop is thinner than that, you will need to double up.

UNDER THE MICROSCOPE MIXER TAP DETAILS

A mixer tap consists of many different components. This summary shows you what the different elements are called and explains what they do.

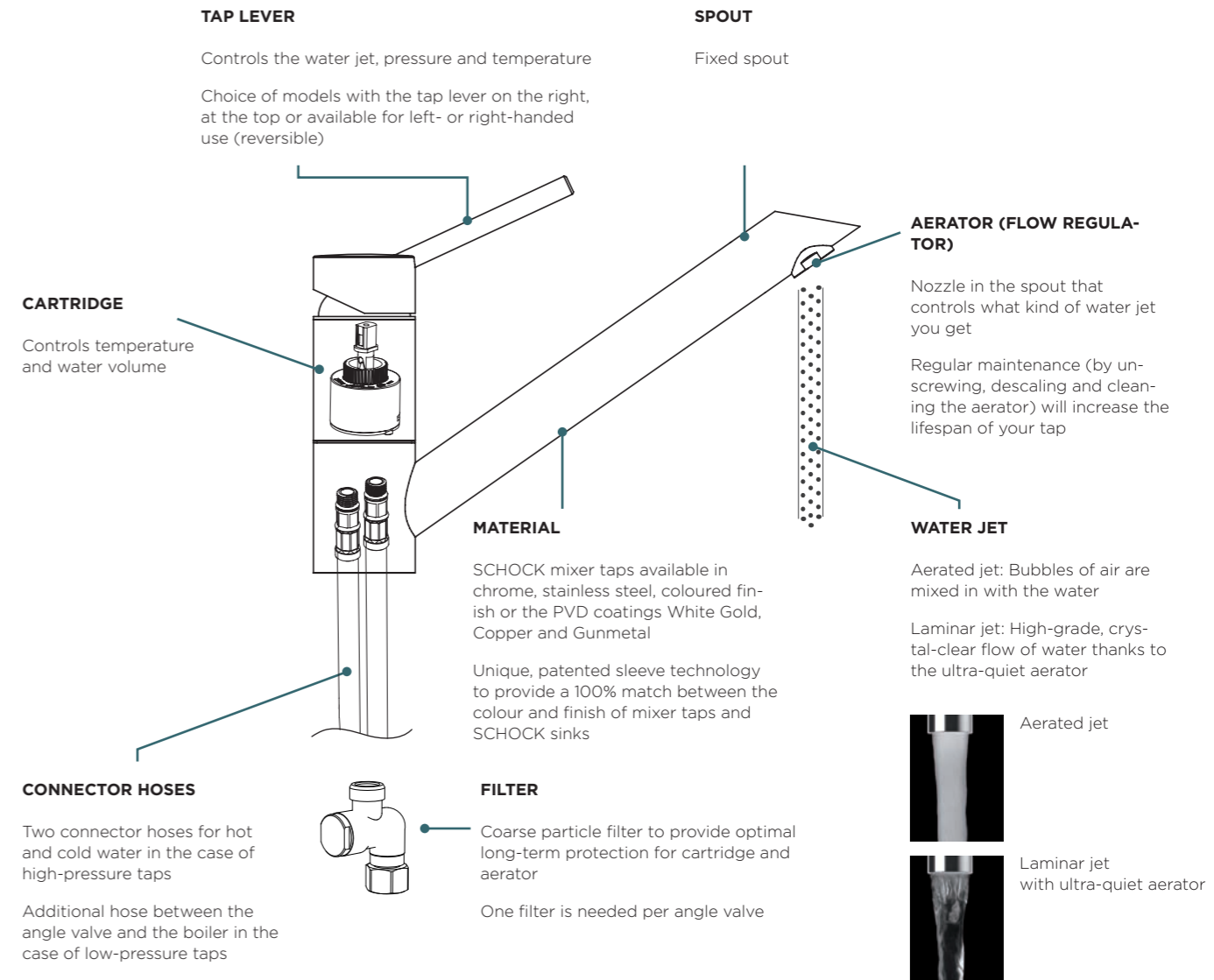

Mixer tap service videos

We recommend you have our products installed by a professional. You can find our service videos on installation and spare parts on the product pages of our website and on our YouTube channel SCHOCK Germany.



HOW THE STORY CONTINUES: OUR SERVICE HINTS AND CARE TIPS

When you buy a SCHOCK product, that's not the end of the story for us. Because products made to last like our SCHOCK sinks and mixer taps are a joy to look at for years to come. Especially if you clean and look after them right. See all our care videos and FAQs in our care guide at www.schock.de/care

Always in the picture - SCHOCK service videos

What's the right way to install a SCHOCK sink or mixer tap? What special features does a product have? What tools do you need? Find all the answers in the service videos from SCHOCK at:



schock.de/gbr_en/servicevideos

Always at the right address - SCHOCK accessories and spare parts shop

With matching accessories and the right care you'll be able to enjoy your SCHOCK sink area even longer and more sustainably. You'll find everything you need to do that, from chopping boards to steamer containers, spare parts to care sets, right here:



shop.schock.de/en

Always taken care of - SCHOCK care sets

The rigours of everyday use can normally be cleaned off our material's finishes simply and easily with a little water and washing-up liquid. For special cases we've put together some environmentally responsible and economical care sets which you can use to remove stains and limescale, etc. Find them at:



shop.schock.de/en/clean-care

THE END?

Far from it! We will go on writing new chapters in our story every day. We can't reveal just yet what the next part of the story will be. But it's safe to say that it will be exciting and it will be colourful. If you'd rather not miss a thing, visit us at www.schock.de/gbr_en and pay a visit to a SCHOCK distributor of your choice.



Follow us on YouTube, Facebook and Instagram for more stories and news from Iggy Pop and the SCHOCK Green Team.



www.schock.de/gbr_en



THE 1810 COMPANY

(A SCHOCK GROUP COMPANY)
Units 14-16 Bromfield Industrial Estate,
Queens Lane, Mold, Flintshire, CH7 1JR

Phone: +44 (0) 1978 660 770

E-mail: sales@the1810company.co.uk

www.schock.de/gbr_en

06/2022

Photographic concept, layout and composition: Studio Michael Schad, Stuttgart

Illustrations: Klaus Pichler, Vienna

Copy: Katrin Schlegel, Die Schreiberei, Krauchenwies

Design of the Mono sink: Mukomelov Studio, Moscow and Kyiv

Design of the Grando, Horizont sink: Platinumdesign, Stuttgart

Design of the Tia, Prepstation, Kyoto, Wembley,

Waterfall sink: Studio Michael Schad, Stuttgart

